

S30 Emergency stop switches



- Φ40mm Mushroom-operator
- Housing made of SUS 304 stainless steel
- High resistance to vibration and impact
- Two ways of resetting -pulling and turning
- High IP67/69K protection
- Oilight model are available
- Quickly connector and PCB connector are available
- TÜV CE RoHS

Mounting Dimensions and styles

304=Φ30+Mushroom Φ40mm

Reset way

Blank =Turn to reset T=Pull to reset

Terminal

L=Solder/Plug-in (2.8*0.5)
S=PCB (1.2*0.7)

Contact arrangement

11=1NO+1NC 02=2NC

Voltage①

06=6VAC/DC 110=110VAC/DC
12=12VAC/DC 220=220VAV/DC
24=24VAC/DC

Color②

R= Red G= Green

Switching rating

Operating mode	Push-to-lock,	
	Turning to reset (Bilateral rotation, clockwise 25°)	
Operator stroke	3.5 mm	
Operating force	Maintained	About 17N
	Spring-return	About 6N·m

Ordering code

Shape	Resetting Way	Contact	Part No.	Terminal	Note
Φ32mm Mushroom illuminated (D3)	Push to lock, Turn to reset	1NO+1NC	S30D3-11Z□①②	·In place of □ insert terminal as follows: L: Solder/ Tab#110 S: PCB Board	In place of ① insert voltage and ② LED color from tab
		2NC	S30D3-02Z□①②		
	Push to lock, Pull to reset	1NO+1NC	S30D3-11ZT□①②		
		2NC	S30D3-02ZT□①②		
Φ28mm Mushroom (4)	Push to lock, Turn to reset	1NO+1NC	S304-11Z□①②		
		2NC	S304-11Z□①②		
	Push to lock, Pull to reset	1NO+1NC	S304-11ZT□①②		
		2NC	S304-11ZT□①②		

Outline Dimensional drawing_{mm}

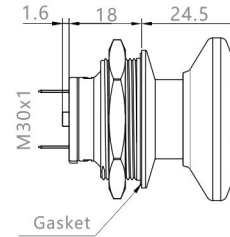

Φ32mm Mushroom head
(Central dot)

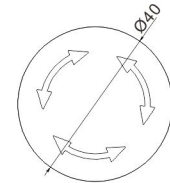
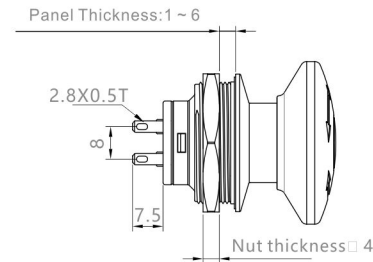

Φ40mm Mushroom head

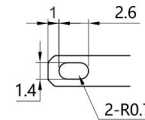

* Solder/Plug-in Terminal

- Mounting Hole Layout & Mini Mounting spacing Reference P32
- Quick connection are possible , The wire length of quick connection on request.

Bottom View

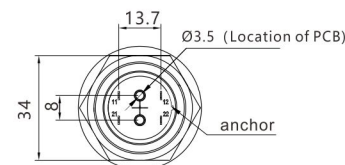

Terminal Arrangement

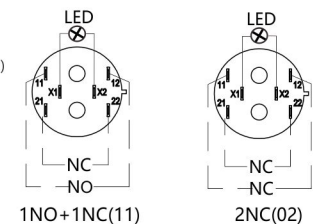

PS: Except for the listed products models, Special and Customized Products are available. please consult the factory for more details.

□ Mounting hole Layout

S22 Series

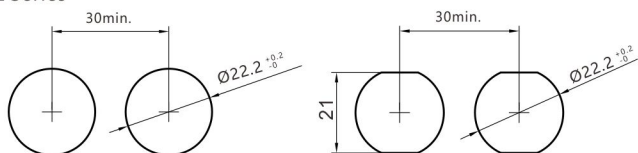

S25 Series

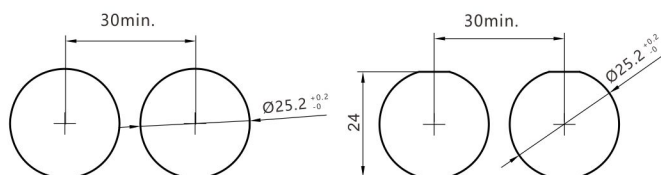

S30 Series

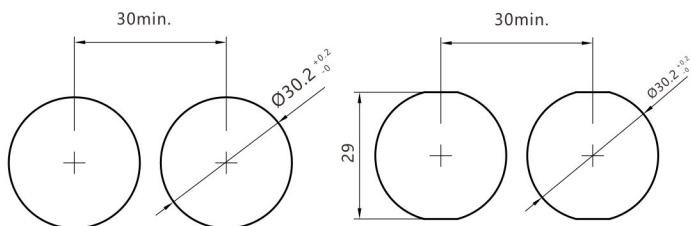

Standard model

bidirectional limit

