

## S25 Pushbuttons



- $\Phi 25\text{mm}$
- Housing made of SUS304 stainless steel
- High resistance to vibration and impact
- Quickly connector and PCB connector are available
- Laser Markings are available for any symbol or text
- High IP67/69K protection
- Oiltight model are available
- TUV CE RoHS

### Mounting Dimensions and styles

25F= $\Phi 25$ + Flat

### Switching action

Blank =Momentary T=Maintained

### Contact arrangement

11 = 1NO+1NC    20 = 2NO  
02 = 2NC

### Terminal

L=Solder/Plug-in (2.8\*0.5)

## Ordering code

Shape	Switching action	Contact	Part No.	Note
Flat (F)	Momentary	1NO+1NC	S25F-11L	
		2NO	S25F-20L	
		2NC	S25F-02L	
	Maintained	1NO+1NC	S25F-11TL	
		2NO	S25F-20TL	
		2NC	S25F-02TL	
Extend (R)	Momentary	1NO+1NC	S25R-11L	
		2NO	S25R-20L	
		2NC	S25R-02L	
	Maintained	1NO+1NC	S25R-11TL	
		2NO	S25R-20TL	
		2NC	S25R-02TL	

### Outline Dimensional drawing<sub>mm</sub>

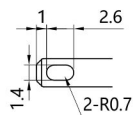
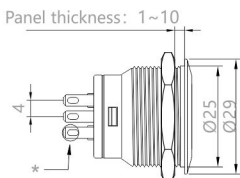
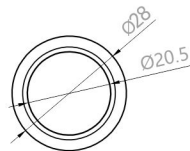
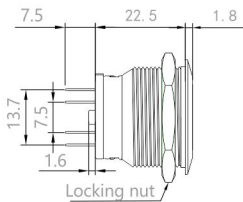

\*Solder/Plug-in Terminal