

## C5 Indicator Sound alarms



- Ø50mm diameter sound alarms model
- Built-in Buzzer, optional 85dB,
- Three colors in one device and five colors to choose from
- Translucent ivory Lens, eliminating false indication from ambient light when off
- Cabled and quick-disconnect model available
- Buzzer depending type or control type
- Models rated to IP67 and IP69K for use in harsh environments

CE

## Specifications

Mounting Hole Diameter	Φ 30mm
Input Voltage	12VAC/DC ;24VAC/DC
Functions	Constant\flashing\Buzzer
Material	Base: Aluminium(anodized), Lens: PC,Nut-PA66
Output	NPN/PNP
Connection	M12 connector (Additional cable) / 1.5M cable
Operating Temperature	-25°C ~ +55°C (No Freezing)
Storage Temperature	-40°C ~ +70°C (No Freezing)
Storage Humidity	40 ~ 85%RH (No condensation)
Vibration Resistance	10 ~ 55Hz, Amplitude 0.75mm
Installation Category	Direct Mounting
	Rod Mounting

## Order code

Shape	Color style	light form	Code		Note
			M12 connector	1.5M Cable	
Ø50mm Sound alarms	Single-color	Constant	C512Q-▲-□	C512-▲-□	Sound alarm models as follows: A, Depend; the Buzzers Separate with LED B, Control; the Buzzers together with the LED red
		Flashing	C511Q-▲-□	C511-▲-□	
	Bi-color	Constant	C522Q-▲-□	C522-▲-□	
		Flashing	C521Q-▲-□	C521-▲-□	
	Tri-color	Constant	C532Q-▲-□	C532-▲-□	
		Flashing	C531Q-▲-□	C531-▲-□	

- Color-code for lighting is "▲" in the model number .  
R: red, Y: Yellow, G: Green, B: Blue, W: White
- code for buzzer is "□" A: depending (5P) ; B: control (4P)

## Outline Dimensional drawing(mm)

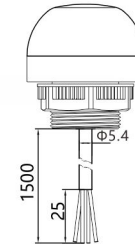
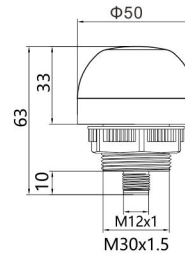
quick connector  
(M12)

1.5m Cable



- Connector(M12) type and Accessories refer to P16
- Cable length are available

## Pinout &amp; Wiring diagram (Tri-color 4P&amp;5P)

Pinout (Female) &amp; wire color

