

Produce Shape

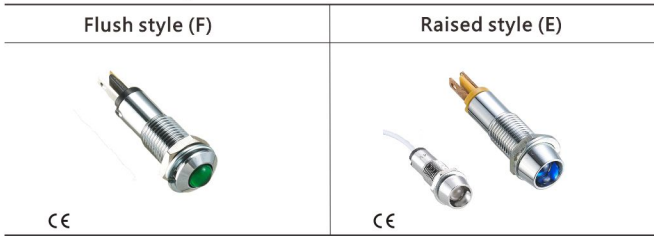

Outline Dimensional drawing (mm)

M8F

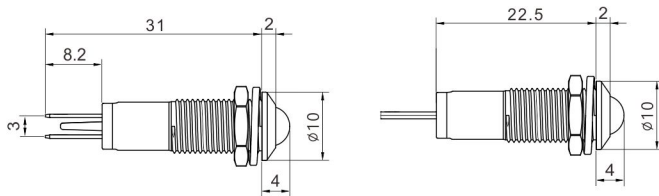

M8E

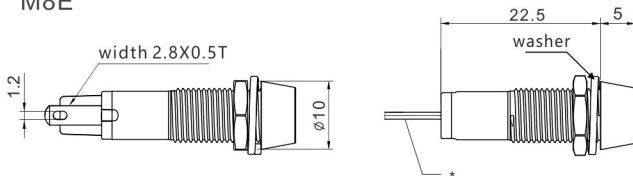

*The cable are available

Mounting Size (mm)

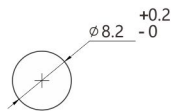

LED Countermeasures against Dim lighting

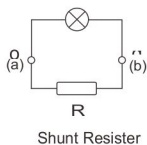

- LED Dim Lighting
Leakage Currents through transistors or a contact protection circuit may cause the LED lamp to illuminate dimly even when the output is off

- Countermeasures
When the LED lamps is illuminated by a transistor output, take the following measure, leakage current shunt resistor allotment table

Model Specification

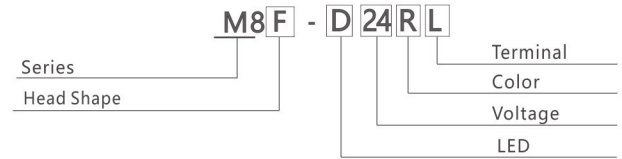

M8 Vandal Proof Pilot lamp

Shape	Code (IP67)		Voltage①	Color②
	M8F-D①②	M8F-D①②L		
Flush(F)	M8F-D①②	M8F-D①②L	Reference the follow tables	Reference the follow tables
Raised(E)	M8E-D①②	M8E-D①②L	Reference the follow tables	Reference the follow tables

Rated Voltage and Operating Current

Model	LED Voltage	Operating Current
Full Voltage	5V AC/DC	—
	12V AC/DC	6.2~6.8mA
	24V AC/DC	7~7.5 mA
	Specific	110V AC/DC
220V AC/DC		1.2~1.7mA

LED Color

Red		R
Green		G
Yellow		Y
Blue		B
White		W
Amber		A

Lamp Life

Model	Life	Judgement Criterion
LED Bulb	30000h	The brightness reduce to 50% of the initial value

• When Lit at the rated voltage under working environment

