

C3T Illuminated touch button and
pick-to-light

- Simple operation with the touch of a finger
- Input/output independent
Output Model NO or NC available
- Inputs/outputs PNP or NPN available,
- one-, two- and three-color models available to solve a variety of applications
- Can be actuated with bare hands or gloves
- Cabled and Quick disconnect models available
- Ideal for use in abusive environments, featuring rugged, fully encapsulated construction.

Specification

| | |
|------------------------------------|--|
| Rated voltage | 24VDC |
| Supply Current | <35mA Max. |
| Supply/output protection Circuitry | Protected against reverse polarity voltages |
| output Rating | Max. load: 150mA , ON-state saturation voltage: <2V dc at 10mA Off-state leakage current < |
| Output response Time | 150 milliseconds on and off |
| Power-up Delay | 300 milliseconds |
| construction | Hosing: Aluminum (Anodizing black) Translucent dome: PC Mounting nut: PA |
| Connections | M12 quick connection or Cable 1.5M |
| Mounting | M22x1 Threaded base, Max torque 2 N•m |
| Operating Conditions | -25°C ~ +55°C ; Humidity: 85% RH (no condensation) |
| Storage Temperature | -40°C ~ +70°C (no freezing) |
| Vibration and Mechanical Shock | All models meet IEC60947-5-2; |
| Environmental Rating | IEC IP67, IP69K per DIN 40050-9 |

Outline Dimensional drawing (mm)

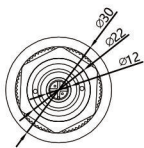
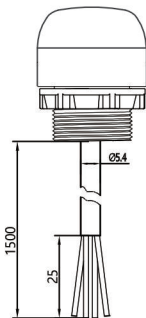
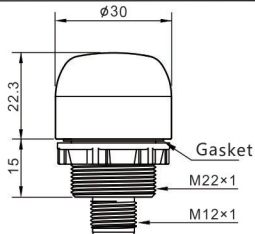

- Pinout & Wiring diagram refer to PG.15
- Connector (M12) type and Accessories refer to P16
- Cable length are available

Order code

| sharp | Input/Output | Connection | Fuction/LED color | order code | | | | |
|---|-------------------------|----------------------------------|-----------------------------------|---------------------|----------------------------------|----------------------------------|----------------|---------------|
| Ø50mm standard models+ Touch Buttons& Pick-to-light | output model: NO | Quick Connector M12 | F1: LED indicator are independent | 1 color | CT1NQ-F1/▲ | | | |
| | | | | 2 color | C3T1NQ-F1/▲•▲ | | | |
| | | | | 2 color | C3T1NQ-F1/▲▲▲ | | | |
| | | | | 3 color | C3T1NQ-F1/▲▲•▲ | | | |
| | | | | 3 color | C3T1NQ-F1/▲▲▲▲ | | | |
| | | | | 1 color | C3T1PQ-F1/▲ | | | |
| | output model: Momentary | Quick Connector M12 | F1: LED indicator are independent | 2 color | C3T1PQ-F1/▲▲▲ | | | |
| | | | | 2 color | C3T1PQ-F1/▲▲▲ | | | |
| | | | | 3 color | C3T1PQ-F1/▲▲•▲ | | | |
| | | | | 3 color | C3T1PQ-F1/▲▲▲▲ | | | |
| | | | | input/output: NPN | Quick Connector M12 | F2: LED indicator are pre-setted | 1 color | C3T1NQ-F2/▲ |
| | | | | | | | 2 color | C3T1NQ-F2/▲•▲ |
| 2 color | C3T1NQ-F2/▲▲▲ | | | | | | | |
| 3 color | C3T1NQ-F2/▲▲•▲ | | | | | | | |
| 3 color | C3T1NQ-F2/▲▲▲▲ | | | | | | | |
| 1 color | C3T1PQ-F2/▲ | | | | | | | |
| output model: NO | Quick Connector M12 | F2: LED indicator are pre-setted | 2 color | C3T1PQ-F2/▲•▲ | | | | |
| | | | 2 color | C3T1PQ-F2/▲▲▲ | | | | |
| | | | 3 color | C3T1PQ-F2/▲▲•▲ | | | | |
| | | | 3 color | C3T1PQ-F2/▲▲▲▲ | | | | |
| | | | output state : Momentary | Quick Connector M12 | F2: LED indicator are pre-setted | 2 color | C3T1PQ-F2/▲▲▲ | |
| | | | | | | 2 color | C3T1PQ-F2/▲▲▲ | |
| 3 color | C3T1PQ-F2/▲▲•▲ | | | | | | | |
| 3 color | C3T1PQ-F2/▲▲▲▲ | | | | | | | |
| input/output: PNP | Quick Connector M12 | F2: LED indicator are pre-setted | | | | 3 color | C3T1PQ-F2/▲▲▲▲ | |
| | | | | | | 3 color | C3T1PQ-F2/▲▲▲▲ | |

- The operating pressure can be pre-set according to the requirements
- A variety of mounting supports and accessories are optional
- other logic functions , contact Goto Engineering.