

S16 Mushroom switches



- $\Phi 16\text{mm}$
- Action: Momentary; Maintained
- Terminal: Solder/Plug-in 2.8×0.5
- Silver alloy/Gold plated silver alloy
- Contact : 1NO+1NC
- IP67
- IEC/EN 60947-5-1,
IEC/EN 60073, IEC/EC 60529

Contact arrangement①

11=1NO+1NC

Switching action②

Blank =Momentary T=Maintained

Mounting dimensions and styles

16FMR= $\Phi 16\text{mm}$ +Mushroom head

Ordering code

Shape	Switching action	Contact	Code	Note
Mushroom head (FMR)	Momentary	1NO+1NC	S16FMR-11L	
	Maintained	1NO+1NC	S16FMR-11TL	

PS: Except for the listed products models, Special and Customized Products are available. please consult the factory for more details.

Outline Dimensional drawing_{mm}

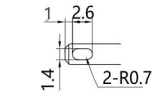
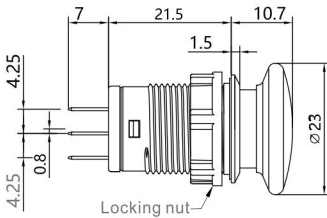

*Solder/Plug-in Terminal

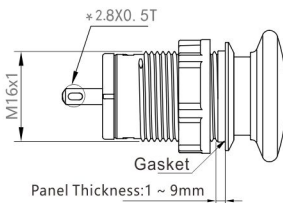

Bottom View



- Mounting Hole Layout & Mini Mounting spacing Reference P32
- Quick connector and wire length is possible.